

## STANDARD EQUIPMENT



# MAS 500 - S6A3 MPTK

### Fuel System

Fuel feed pump  
Change over type fuel filters  
Fuel injection pump  
Shielded fuel injection lines

### Lubricating Oil System

Oil pressure alarm switch  
Full-flow lubricating oil filters (change over type)  
By-pass filter (change over type)  
Oil cooler with thermostat

### Cooling System

Fresh water pump  
Thermostats with by-pass

### Electric System

Starter motor  
Alternator 30 Amps

### Inlet and Exhaust System

Turbo chargers MITSUBISHI  
Inlet air main fold with air cleaner  
Dry type exhaust main fold with vertical outlet, counter flange

### Other Standard Equipment

Hydraulic governor  
Mounting brackets

### Alternator

Stamford type HMC  
Engine and alternator are mounted on a welded steel base frame, installed on vibration dampers

## TECHNICAL DATA

Power	Cylinders	Diameter x Bore	Total Cylinder Capacity	Injection System	Starting System	Fly head	Dry Weight
50 Hz -513 Kva -1500 Rpm 60 Hz -380 Kva -1200 Rpm 60 Hz -570 Kva -1800 Rpm	6 cylinders	150x175 mm	18.5 liters	Direct	24 Volts bi-polar	SAE 14 / SAE 1	4200 kgs

## Options

### Classification

BV, LRS, DNV classification (and other). IMO classification

### Engine cooling system

Heat exchanger fresh water / raw water (turbo lair or combined)  
Plate cooler  
Box cooler  
Keel cooling  
Mounted seawater pump  
Electric seawater pump

### Exhaust

Flexible expansion joint  
Silencer 22 db or 35 db or others  
Spark-arrestor

### Lubricating oil system

Manual oil drain pump  
Electric oil drain pump  
Pre-lubricating pump  
Emergency oil pump

### starting system

Air starting  
Electric compressor set  
Air / electrical combined starting

### Instrumental panel

Single- or multi-stations  
Mechanical or electronic remote control

### Alternator

Other brands like LEROY SOMER, etc...

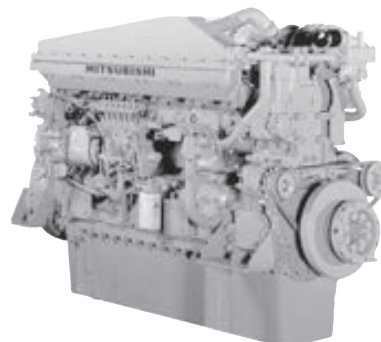

**S6A3 MPTK** 6-cylinder, 4-cycle, Water cooled, Diesel Engine Direct-injection, Turbocharged with Air-cooler  
Bore x Stroke (mm) : 150 x 175  
Displacement (L) : 18.56

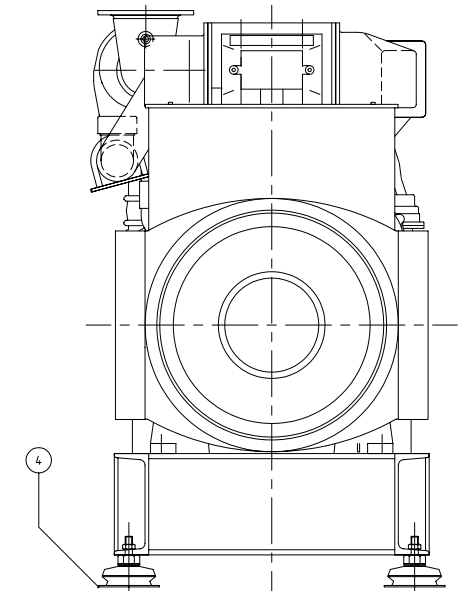
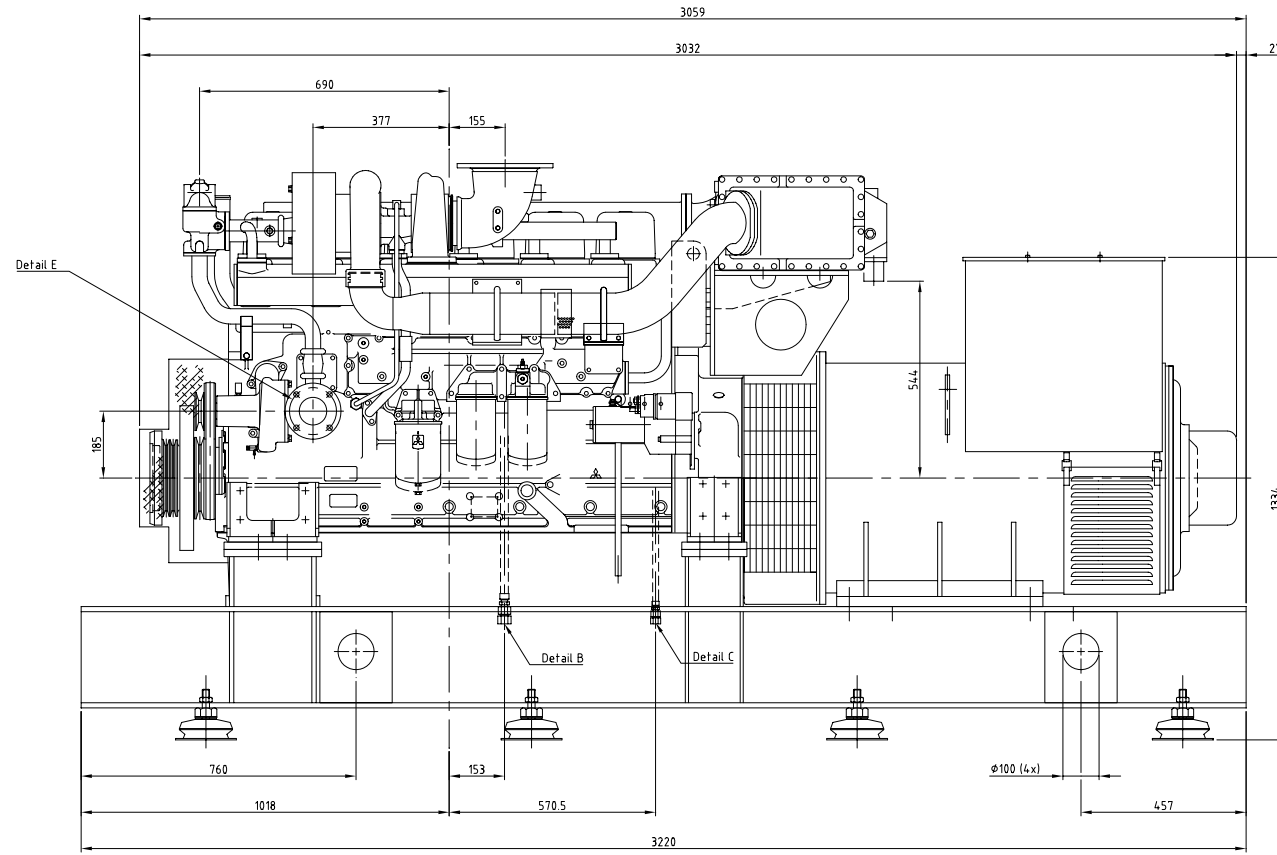
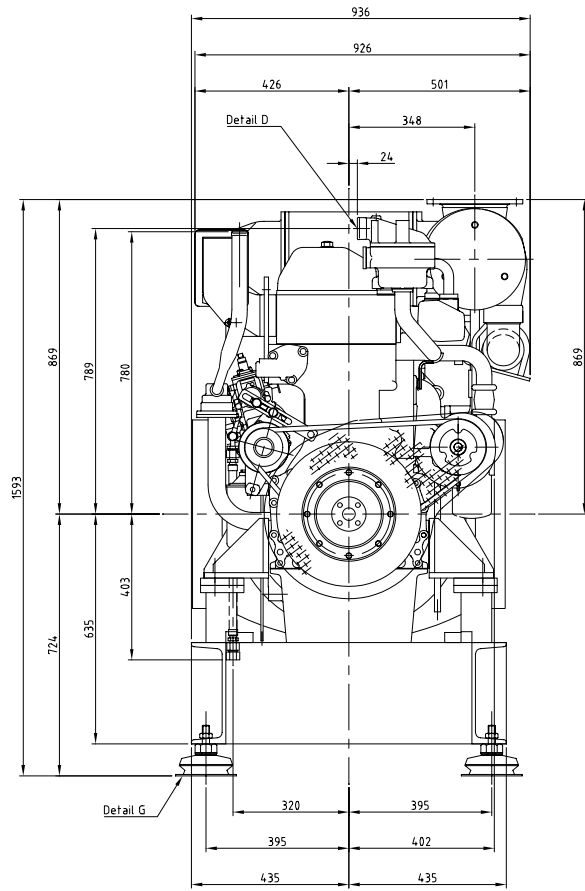
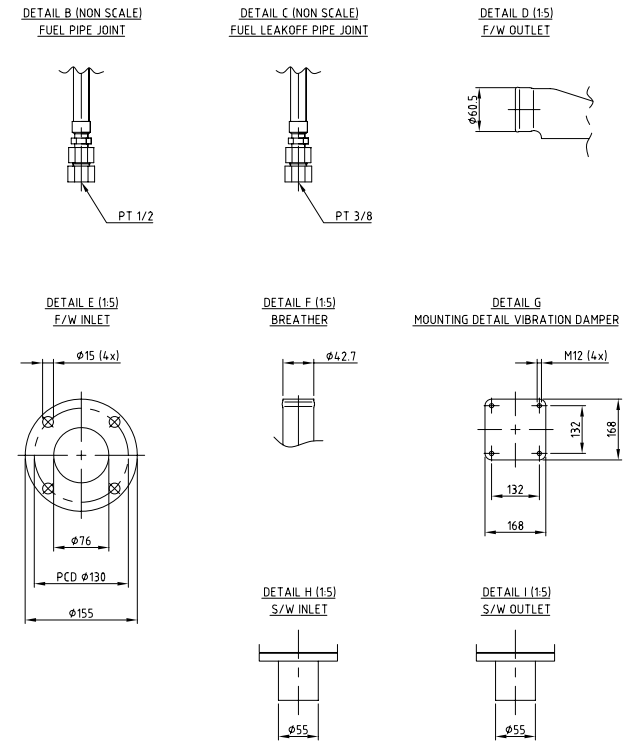
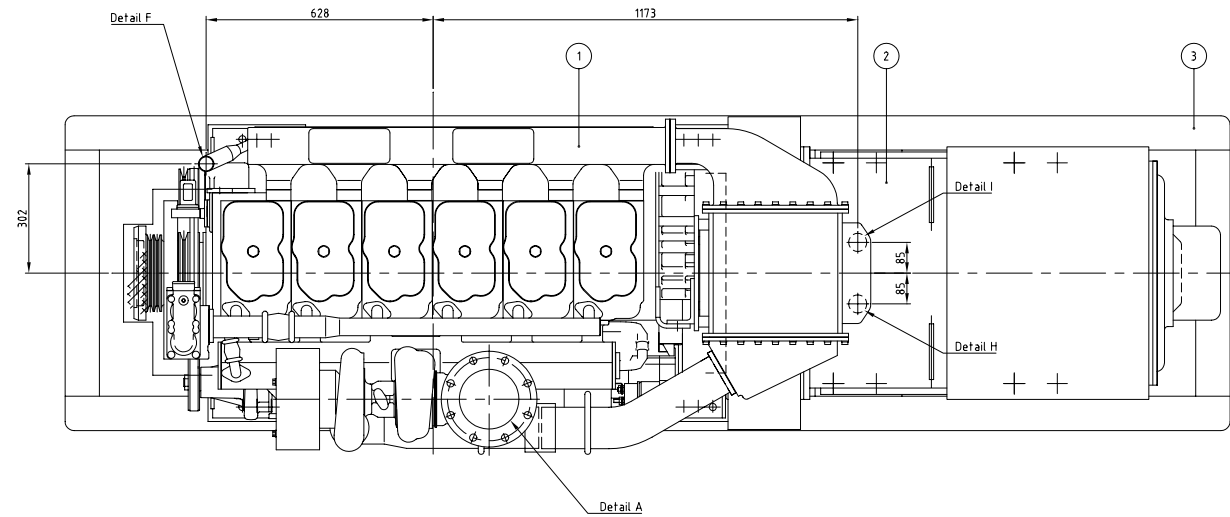
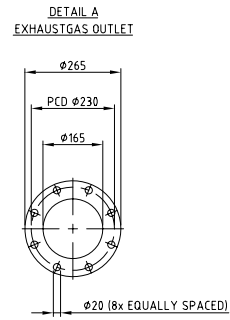

NOTE:  
UNDER EVERY FILTER A DRIPTRAY WILL BE INSTALLED  
ALL ROTATING PARTS WILL BE COVERED

FOR INFORMATION ONLY

No.	Date	Description of change		
Subject		MAS 500		
Type		1500 rpm		
4	8	VIBRATION DAMPER TV 053 I/A		
3	I	FRAME		
2	I	GENERATOR HCM534E1		
1	I	ENGINE S6A3-MPTK		
POS No.	QUAN TITY	DESCRIPTION	TYPE	MATERIAL
				STEEL

Type	S6A3-MPTK HCM534E1	Project No.	
Drawn	G.J.G.	Checked	
Date	FEB 99	Date	
Scale	1:10	Filename	B00696-0
Size	A1	Rev	0
MHI EQUIPMENT EUROPE B. V.		Drawing number:	
EUROPEAN SALES AND SERVICE SUBSIDIARY OF MITSUBISHI HEAVY INDUSTRIES LTD. - JAPAN		B00696-0	
		Sheet No. 1/1	
all rights reserved			